

OPERATION AND INSTALLATION

Rapid heater

- » CK 20 S
- » CKZ 20 S
- » CKR 20 S
- » CKT 20 S

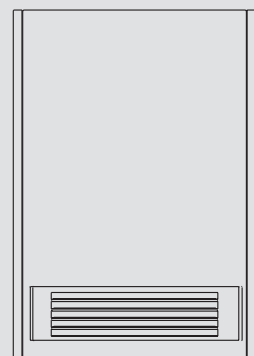

STIEBEL ELTRON

SPECIAL INFORMATION

OPERATION

| | |
|---|----------|
| 1. General information | 3 |
| 1.1 Safety instructions | 3 |
| 1.2 Other symbols in this documentation | 3 |
| 1.3 Information on the appliance | 3 |
| 1.4 Units of measurement | 3 |
| 2. Safety | 3 |
| 2.1 Intended use | 3 |
| 2.2 General safety instructions | 4 |
| 2.3 Test symbols | 4 |
| 3. Appliance description | 4 |
| 4. Operation CK 20 S | 4 |
| 4.1 Start heating | 4 |
| 4.2 Control with external room temperature controller | 5 |
| 4.3 Stopping heating / frost protection | 5 |
| 4.4 Decommissioning | 5 |
| 5. Operation CKZ 20 S | 5 |
| 5.1 Start heating | 5 |
| 5.2 Stopping heating / frost protection | 5 |
| 5.3 Decommissioning | 5 |
| 6. Operation CKR 20 S | 5 |
| 6.1 Start heating | 5 |
| 6.2 Control with external room temperature controller | 6 |
| 6.3 Stopping heating / frost protection | 6 |
| 6.4 Decommissioning | 6 |
| 7. Operation CKT 20 S | 6 |
| 7.1 Start heating | 6 |
| 7.2 Adjusting the time switch | 6 |
| 7.3 Stopping heating / frost protection | 6 |
| 7.4 Decommissioning | 6 |
| 8. Cleaning, care and maintenance | 6 |
| 9. Storage | 6 |
| 10. Troubleshooting | 6 |

INSTALLATION

| | |
|--|----------|
| 11. Safety | 7 |
| 11.1 General safety instructions | 7 |
| 11.2 Instructions, standards and regulations | 7 |
| 12. Appliance description | 7 |
| 12.1 Standard delivery | 7 |
| 13. Preparations | 7 |
| 13.1 Minimum clearances | 7 |
| 14. Installation | 7 |
| 15. Power supply | 7 |
| 16. Appliance handover | 8 |
| 17. Troubleshooting | 8 |
| 18. Specification | 8 |
| 18.1 Dimensions and connections | 8 |
| 18.2 Wiring diagram CK 20 S | 9 |
| 18.3 Wiring diagram CKZ 20 S | 9 |
| 18.4 Wiring diagram CKR 20 S | 10 |
| 18.5 Wiring diagram CKT 20 S | 10 |

| | |
|-----------------|----|
| 18.6 Data table | 11 |
|-----------------|----|

GUARANTEE

ENVIRONMENT AND RECYCLING

AUSTRALIA - CUSTOMER SERVICE AND WARRANTY

SPECIAL INFORMATION

- Keep children under the age of 3 away from the appliance if constant supervision cannot be guaranteed.
- Children from the age of 3 to 7 may switch the appliance on and off, provided they are supervised or have been instructed in the safe operation of the appliance and understand any risks that may result. This is subject to the appliance having been installed as described. Children from the age of 3 to 7 must not plug the power cable into its socket nor regulate the appliance.
- The appliance may be used by children aged 8 and older and persons with reduced physical, sensory or mental capabilities or a lack of experience and know-how, provided that they are supervised or they have been instructed on how to use the appliance safely and have understood the resulting risks.
- Children must never play with the appliance. Children must never clean the appliance or perform user maintenance unless they are supervised.
- The appliance could continue to heat the room unchecked if it is operated on a time switch. Ensure constant supervision if the appliance is used in a small room and the persons within that room cannot leave the room on their own.
- Parts of the appliance can get very hot and may cause burns. Particular caution is advised when children or vulnerable persons are present.
- Never cover the appliance.
- Never install the appliance directly below a wall socket.

OPERATION

General information

- Install the appliance in such a way that the control equipment cannot be touched by a person in the bath or shower.
- In the case of a permanent connection, the appliance must be able to be separated from the power supply by an isolator that disconnects all poles with at least 3 mm contact separation.
- In the event of damage to the power cable this must always be replaced by a qualified contractor authorised by the manufacturer, using original spare parts.
- Secure the appliance as described in chapter "Installation / Installation".

OPERATION

1. General information

The chapters "Special Information" and "Operation" are intended for both the user and qualified contractors.

The chapter "Installation" is intended for qualified contractors.



Note

Read these instructions carefully before using the appliance and retain them for future reference. Pass on the instructions to a new user if required.

1.1 Safety instructions

1.1.1 Structure of safety instructions



KEYWORD Type of risk

Here, possible consequences are listed that may result from failure to observe the safety instructions.

► Steps to prevent the risk are listed.

1.1.2 Symbols, type of risk

| Symbol | Type of risk |
|--------|-------------------------|
| | Injury |
| | Electrocution |
| | Burns (burns, scalding) |

1.1.3 Keywords

| KEYWORD | Meaning |
|---------|--|
| DANGER | Failure to observe this information will result in serious injury or death. |
| WARNING | Failure to observe this information may result in serious injury or death. |
| CAUTION | Failure to observe this information may result in non-serious or minor injury. |

1.2 Other symbols in this documentation



Note

General information is identified by the adjacent symbol. ► Read these texts carefully.

| Symbol | Meaning |
|--------|--|
| | Material losses (appliance damage, consequential losses and environmental pollution) |
| | Appliance disposal |

► This symbol indicates that you have to do something. The action you need to take is described step by step.

1.3 Information on the appliance

| Symbol | Meaning |
|--------|---------------------------|
| | Never cover the appliance |

1.4 Units of measurement



Note

All measurements are given in mm unless stated otherwise.

2. Safety

Operate the appliance only when fully installed and with all safety equipment fitted.

2.1 Intended use

This appliance is intended for domestic use. It can be used safely by untrained persons. The appliance can also be used in a non-domestic environment, e.g. in a small business, as long as it is used in the same way.

Any other use beyond that described shall be deemed inappropriate. Observation of these instructions and of instructions for any accessories used is also part of the correct use of this appliance.

2.2 General safety instructions



WARNING Injury

- Keep children under the age of 3 away from the appliance if constant supervision cannot be guaranteed.
- Children from the age of 3 to 7 may switch the appliance on and off, provided they are supervised or have been instructed in the safe operation of the appliance and understand any risks that may result. This is subject to the appliance having been installed as described.
Children from the age of 3 to 7 must not plug the power cable into its socket nor regulate the appliance.
- The appliance may be used by children aged 8 and older and persons with reduced physical, sensory or mental capabilities or a lack of experience and know-how, provided that they are supervised or they have been instructed on how to use the appliance safely and have understood the resulting risks.
- Children must never play with the appliance. Children must never clean the appliance or perform user maintenance unless they are supervised.



WARNING Burns

Never operate this appliance...

- if the minimum clearances to adjacent object surfaces are not maintained, for example to furniture, net curtains, curtains, textiles or other flammable materials (for minimum clearances, see "Installation / Preparations").
- in rooms where the appliance is at risk of fire or explosion as a result of chemicals, dust, gases or vapours.
- in the direct proximity of pipes or receptacles that carry or contain flammable or explosive materials.
- if work such as laying cables, grinding or sealing is carried out in the installation room.
- if sprays, floor polish or similar products containing naphtha are used. Ventilate the room sufficiently before heating.
- if an appliance component is damaged, the appliance has fallen over or already has a fault.



WARNING Burns

Never place any flammable, combustible or insulating objects or materials, such as laundry, blankets, magazines, containers with floor polish or naphtha, spray cans or similar on the appliance or in direct proximity to it.



WARNING Burns

Ensure that no foreign bodies enter the ventilation and extract air apertures. This could result in electric shock or fire or in damage to the appliance.



WARNING Burns

To prevent fires ensure that the air inlets and outlets are never blocked. Never position the appliance on soft surfaces, such as a bed, as this could result in the apertures becoming blocked.



CAUTION Injury

The appliance could continue to heat the room unchecked if it is operated on a time switch. Ensure constant supervision if the appliance is used in a small room and the persons within that room cannot leave the room on their own.



CAUTION Burns

Parts of the appliance can get very hot and may cause burns. Particular caution is advised when children or vulnerable persons are present.



Material losses

- Never cover the appliance.
- Never step on the appliance.
- Never operate the appliance in the open air.

2.3 Test symbols

See type plate on the appliance.

3. Appliance description

This appliance is wall mounted and is particularly suitable for work rooms, kitchens, bathrooms, wash rooms and similar.

The external casing of the appliance is made from stove enamelled sheet steel. The sides are made from plastic. The controls are located on the r.h. side panel.

The quiet fan draws in the ambient air that is heated by a bare wire heater element. The air then exits evenly through the hot air channel and the air outlet grille set into the bottom of the appliance.

The appliance heats up the ambient air inside the room and maintains it at the selected temperature.

After mounting the appliance on the wall and making the electrical connection using a mains plug, the appliance is ready for operation.

4. Operation CK 20 S

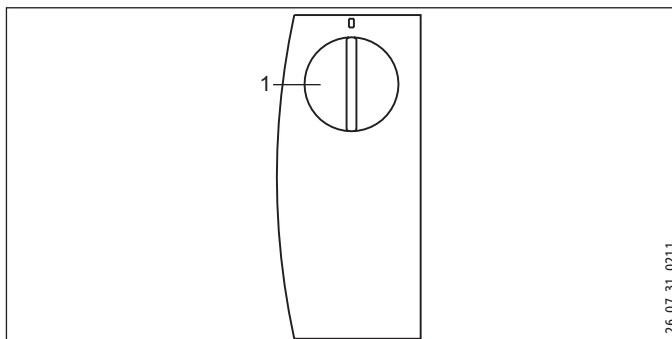

1 Temperature selector

4.1 Start heating

The temperature is variably adjustable. The appliance switches off as soon as the selected room temperature has been reached.

- Turn the temperature selector clockwise to the required setting.

4.2 Control with external room temperature controller

In rooms larger than 20 m² you can operate the appliance with a conventional external room temperature controller.

- To do so, turn the temperature selector fully clockwise.

4.3 Stopping heating / frost protection

- Turn the temperature selector fully anti-clockwise.

This position ensures frost protection. The heating system starts automatically if the room temperature drops below the frost protection temperature.

4.4 Decommissioning

- Pull the plug from the power socket.

5. Operation CKZ 20 S

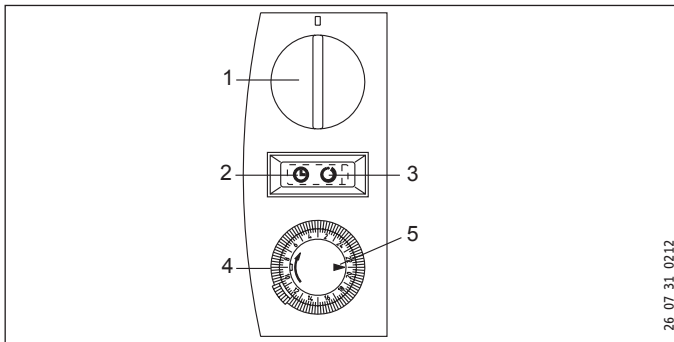

- 1 Temperature selector
- 2 Rocker switch position (operation with the time switch)
- 3 Rocker switch position (standard operation)
- 4 Time switch
- 5 Marker arrow

5.1 Start heating

- Use the rocker switch to select one of the following operating modes:
 - Standard operation
 - Operation with the time switch

Standard operation

The temperature is variably adjustable. The appliance switches off as soon as the selected room temperature has been reached.

- Turn the temperature selector clockwise to the required setting.

Operation with the time switch

The 24-hour time switch has 96 time segments. Every hour is divided into 4 time segments of 15 minutes. The time switch has to be reset when commissioning the appliance and after any power interruption. To do this, turn the time switch clockwise until the marker arrow points to the current time.

To select the required heating time, proceed as follows:

Press down the time segments around the circumference. Red markings will become visible, indicating the preselected heating time at which the appliance automatically starts to heat. If the required room temperature has been reached during the heat-up time, the appliance switches off. It starts again if there is a further heat demand and will continue doing so until the selected heating time has elapsed. This process is repeated daily. The heating time can be adjusted at any time if required by pressing time segments up or down.

5.2 Stopping heating / frost protection

- Turn the temperature selector fully anti-clockwise.

In this setting, frost protection is only ensured if the rocker switch is positioned for "Standard operation". The heating system starts automatically if the room temperature drops below the frost protection temperature.

5.3 Decommissioning

- Pull the plug from the power socket.

6. Operation CKR 20 S

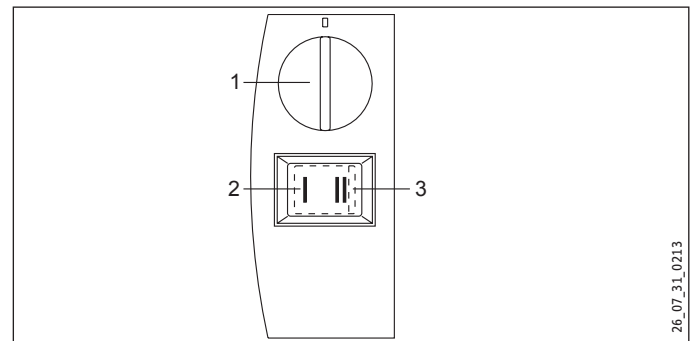

- 1 Temperature selector
- 2 Rocker switch stage (base heating stage)
- 3 Rocker switch stage (quick heating stage)

6.1 Start heating

- Turn the temperature selector clockwise to the required setting.

The temperature is variably adjustable. The appliance switches off as soon as the selected room temperature has been reached.

You can use the rocker switch to choose between the following two outputs with matched fan motor speed:

Base heating stage

Set the rocker switch to "I". Provided that the appliance has been switched on via the temperature selector, it will heat with an output of 1000 W at the slow fan stage.



Note

Never operate the appliance at standard heating stage I, if the room where the appliance has been installed has cooled down severely.

- If the room has cooled down severely, switch the appliance to rapid heating stage II in order to ensure normal appliance operation.

Quick heating stage

Set the rocker switch to "II". Provided that the appliance has been switched on via the temperature selector, it will heat with an output of 2000 W at the quick fan stage.

Select the powerful quick heating stage if you need to heat up a cold room rapidly to the selected temperature. Afterwards, set the rocker switch back to stage "I".

Once the preselected room temperature has been reached, the appliance switches off. The appliance then starts and stops heating as necessary to keep the room temperature constant.

6.2 Control with external room temperature controller

In rooms larger than 20 m² you can operate the appliance with a conventional external room temperature controller.

- To do so, turn the temperature selector fully clockwise.

6.3 Stopping heating / frost protection

- Turn the temperature selector fully anti-clockwise and select quick heating stage "II" on the rocker switch.

This position ensures frost protection. The heating system starts automatically if the room temperature drops below the frost protection temperature.

6.4 Decommissioning

- Pull the plug from the power socket.

7. Operation CKT 20 S

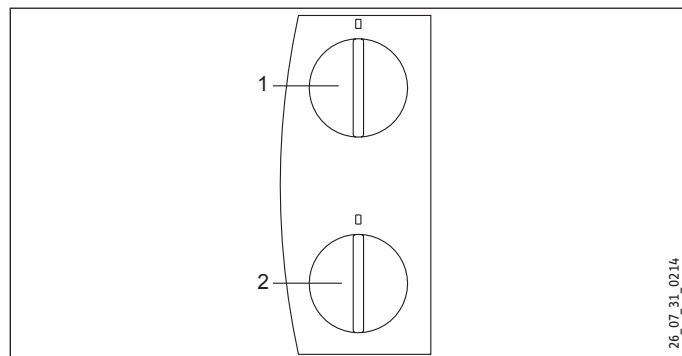

- 1 Temperature selector
- 2 Time switch

7.1 Start heating

The temperature is variably adjustable. The appliance switches off as soon as the selected room temperature has been reached.

- Turn the temperature selector clockwise to the required setting.

7.2 Adjusting the time switch

With the time switch, the appliance heats with full output and without temperature control.

- Turn the time switch selector clockwise to set any number of minutes to count down, from 0 - 60 minutes.

7.3 Stopping heating / frost protection

- Turn the temperature selector fully anti-clockwise and ensure that the time switch is set to "0".

This position ensures frost protection. The heating system starts automatically if the room temperature drops below the frost protection temperature.

7.4 Decommissioning

- Pull the plug from the power socket.

8. Cleaning, care and maintenance

The appliance contains no user serviceable parts.

Clean the appliance when cold with ordinary cleaning products. Avoid abrasive or corrosive cleaning products.

If a pale brownish discolouration appears on the appliance casing, wipe this off as soon as possible with a damp cloth.



Material losses

Never spray cleaning spray into the air slot.

9. Storage

- When not in use, keep the appliance in a dry place.

10. Troubleshooting

If the appliance does not heat, check the temperature set at the appliance and the MCB/fuse in your fuse box.

The appliance has a safety temperature controller that shuts the appliance down if it overheats. After the cause has been removed (for example air outlet or inlet apertures covered) and the appliance has cooled down for a few minutes, operation starts again.

If you cannot remedy the fault, notify your heating contractor. To facilitate and speed up your enquiry, please provide the serial number from the type plate (000000-0000-000000).

INSTALLATION

11. Safety

Only a qualified contractor should carry out installation, commissioning, maintenance and repair of the appliance.

11.1 General safety instructions

We guarantee trouble-free function and operational reliability only if original accessories and spare parts intended for the appliance are used.

11.2 Instructions, standards and regulations



Note

Observe all applicable national and regional regulations and instructions.

12. Appliance description

This appliance is a wall mounted electric direct heater. This appliance is particularly suitable for heating rooms, such as work rooms, kitchens, bathrooms, wash rooms etc.

12.1 Standard delivery

The following are delivered with the appliance:

- Wall mounting bracket
- Fixing bracket

13. Preparations

13.1 Minimum clearances

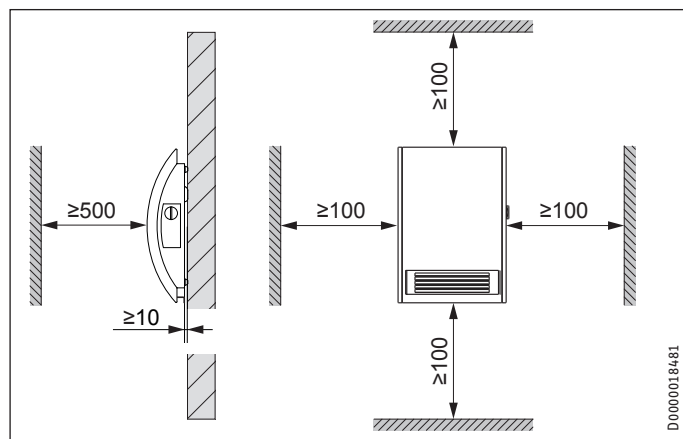

14. Installation



WARNING Electrocutation

- If installing the appliance in rooms with a bath and/or shower, take the relevant safety zone into account in accordance with the information on the appliance type plate.
- Install the appliance in such a way that control equipment cannot be touched by a person in the bath or shower.



WARNING Burns

- Only fit the appliance to a vertical wall that is temperature-resistant to at least 90 °C.
- Maintain minimum clearances to adjacent surfaces.
- Never install the appliance directly below a wall socket.

- ▶ Check the hole distances for the wall mounting bracket in the dimensioned drawing.
- ▶ Secure the wall mounting bracket with suitable fixing materials. The horizontal and vertical slots in the wall mounting bracket enable alignment if drilled holes are not completely accurate.
- ▶ Position the appliance against the wall so that the two protrusions in the top of the back panel grip into the slots in the wall mounting bracket.
- ▶ Secure the appliance with the mounting bracket and one screw to prevent unintentional unhooking. Hook the mounting bracket into the back panel from the lower rear.

15. Power supply



WARNING Electrocutation

Carry out all electrical connection and installation work in accordance with relevant regulations.



Material losses

Observe the type plate. The specified voltage must match the mains voltage.

- The cable must not touch the appliance.
- When connecting the appliance via a standard socket, ensure that this is easily accessible once the appliance has been installed.
- Never install the appliance directly below a wall socket.
- If a permanent connection is required, trim the cable (cut off the plug) so that it runs directly to the appliance junction box.
- In the case of a permanent connection, the appliance must be able to be separated from the power supply by an isolator that disconnects all poles with at least 3 mm contact separation.
- This appliance is unsuitable for fixed cables.

16. Appliance handover

Explain the functions of the appliance to the user. Draw special attention to the safety instructions. Hand over the operating and installation instructions to the user.

17. Troubleshooting

The power cable must only be replaced by a qualified contractor using original spare parts supplied by us.

18. Specification

18.1 Dimensions and connections

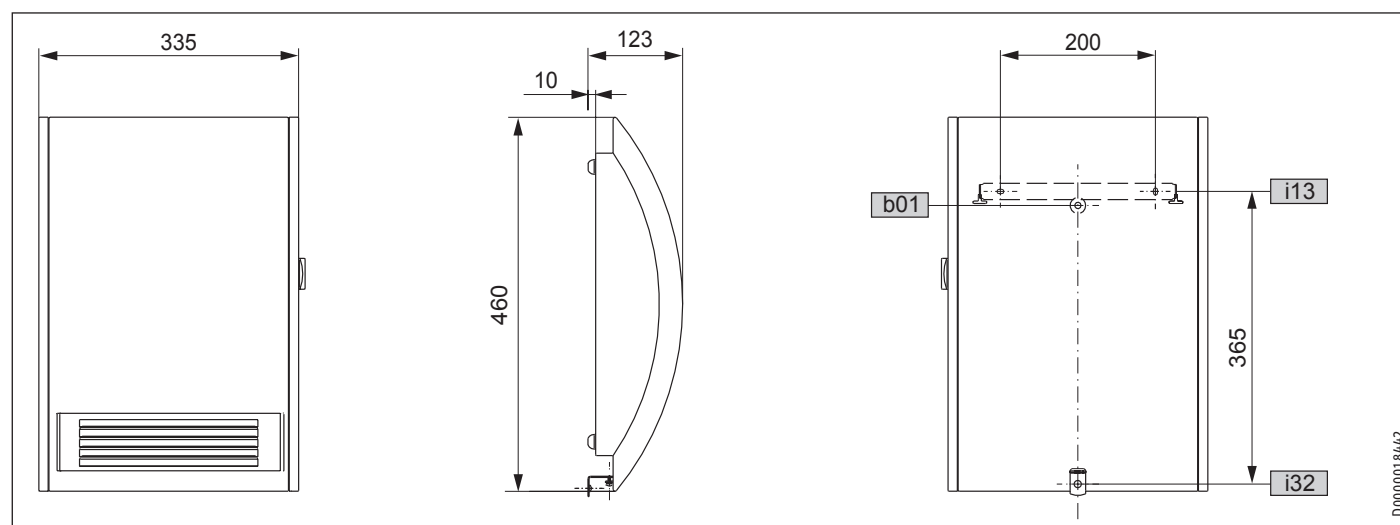

18.2 Wiring diagram CK 20 S

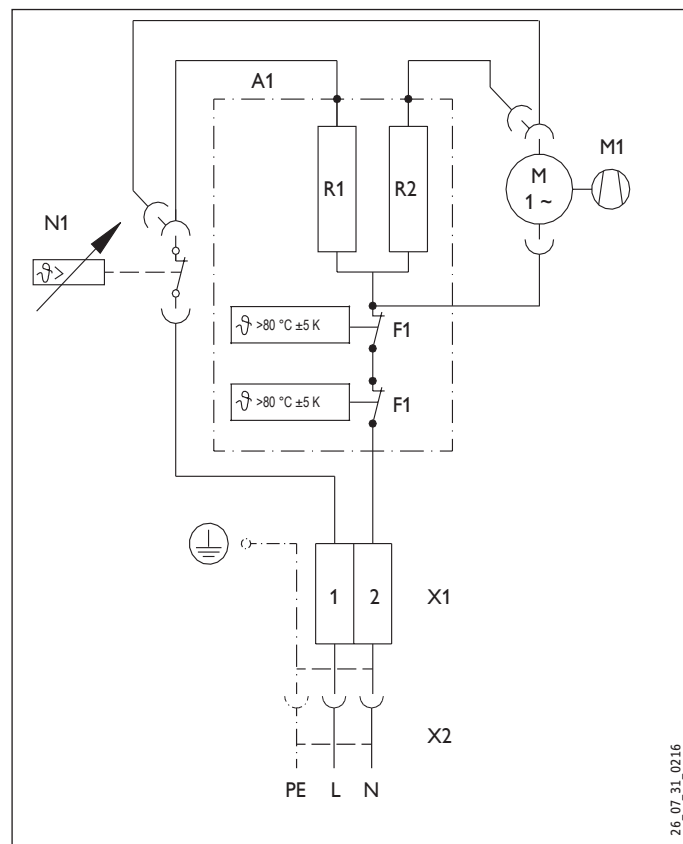

- A1 Electric heater element assembly
- F1 Overheating protection
- M1 Fan
- N1 Temperature controller
- R1 Heating resistor
- R2 Heating resistor
- X1 Socket terminal
- X2 Plug-in connection

18.3 Wiring diagram CKZ 20 S

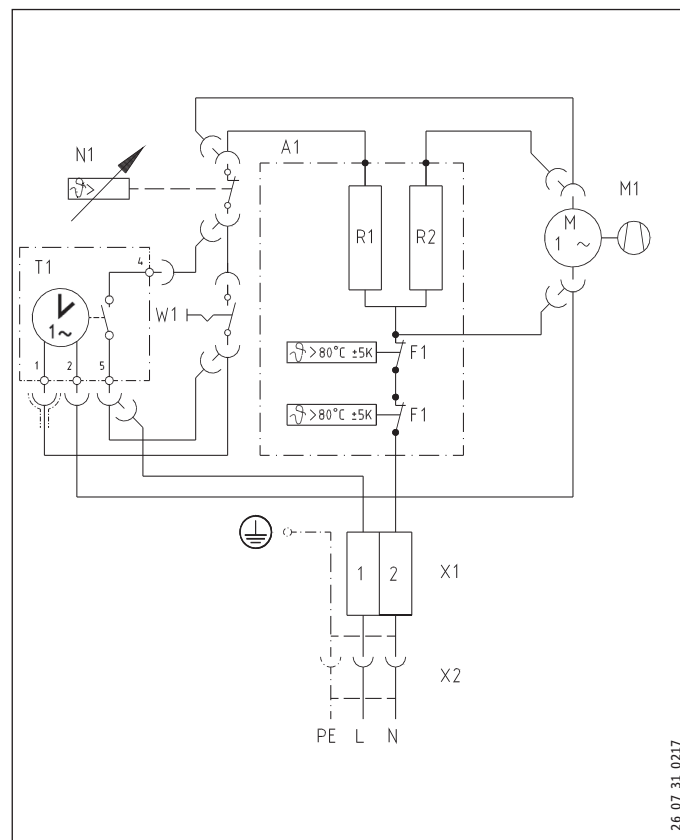

- A1 Electric heater element assembly
- F1 Overheating protection
- M1 Fan
- N1 Temperature controller
- R1 Heating resistor
- R2 Heating resistor
- T1 Time switch
- W1 Rocker switch
- X1 Socket terminal
- X2 Plug-in connection

18.4 Wiring diagram CKR 20 S

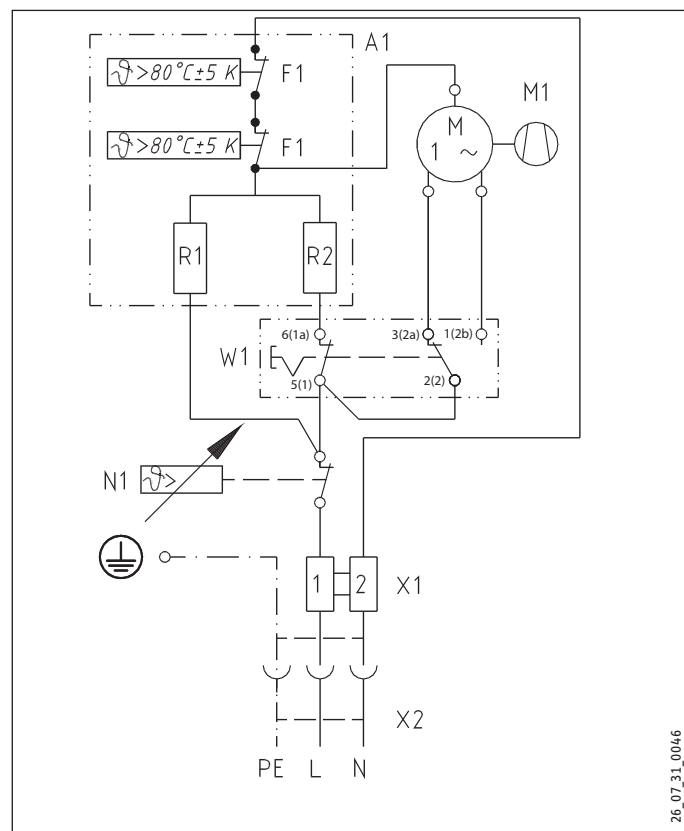

- A1 Electric heater element assembly
- F1 Overheating protection
- M1 Fan
- N1 Temperature controller
- R1 Heating resistor
- R2 Heating resistor
- W1 Rocker switch
- X1 Socket terminal
- X2 Plug-in connection

18.5 Wiring diagram CKT 20 S

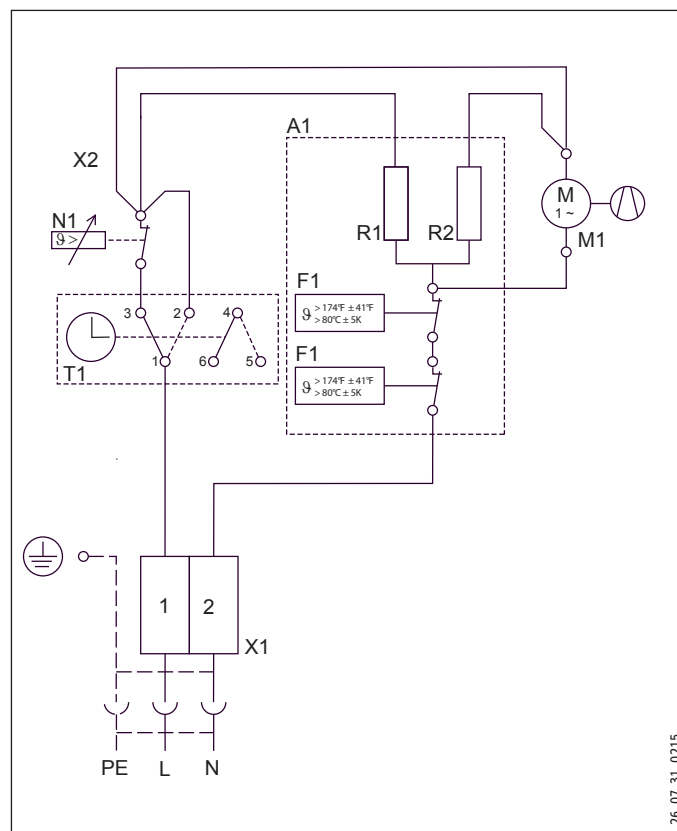

- A1 Electric heater element assembly
- F1 Overheating protection
- M1 Fan
- N1 Temperature controller
- R1 Heating resistor
- R2 Heating resistor
- T1 60 minute time switch
- X1 Socket terminal strip

INSTALLATION

Specification

18.6 Data table

| | | CK 20 S | CKZ 20 S | CKR 20 S | CKT 20 S |
|--------------------------|-------|------------------|--------------|----------------------------|--------------|
| Part number | | 071793 | 071795 | 072633 | 230344 |
| Electrical data | | | | | |
| Connected load | W | 2000 | 2000 | 2000 | 2000 |
| Phases | | 1/N/PE | 1/N/PE | 1/N/PE | 1/N/PE |
| Rated voltage | V | 230 | 230 | 230 | 230 |
| Frequency | Hz | 50 | 50 | 50 | 50 |
| Dimensions | | | | | |
| Height | mm | 460 | 460 | 460 | 460 |
| Width | mm | 335 | 335 | 335 | 335 |
| Depth | mm | 123 | 123 | 123 | 123 |
| Weights | | | | | |
| Weight | kg | 4.4 | 4.4 | 4.4 | 4.4 |
| Versions | | | | | |
| Version | | 24 h time switch | | 60-minute short-time timer | |
| Frost protection setting | °C | 7 | 7 | 7 | 7 |
| IP rating | | IP13B | IP13B | IP13B | IP13B |
| Protection class | | I | I | I | I |
| Colour | | Alpine white | Alpine white | Alpine white | Alpine white |
| Values | | | | | |
| Output stages | | 1.0 / 2.0 kW | | | |
| Setting range | °C | 5-30 | 5-30 | 5-30 | 5-30 |
| Operating noise | dB(A) | 53 | 53 | 42/51 | 53 |

Guarantee

The guarantee conditions of our German companies do not apply to appliances acquired outside of Germany. In countries where our subsidiaries sell our products a guarantee can only be issued by those subsidiaries. Such guarantee is only granted if the subsidiary has issued its own terms of guarantee. No other guarantee will be granted.

We shall not provide any guarantee for appliances acquired in countries where we have no subsidiary to sell our products. This will not affect warranties issued by any importers.

Environment and recycling

We would ask you to help protect the environment. After use, dispose of the various materials in accordance with national regulations.

NOTES

AUSTRALIA

CUSTOMER SERVICE AND WARRANTY

Stiebel Eltron Warranty for Hand Dryers & Space Heaters – Models HTE, ULTRONIC, CNS, CK & CK Z.

Who gives the warranty

1. The warranty is given by Stiebel Eltron (Aust) Pty Ltd (A.B.N. 82 066 271 083) of 294 Salmon Street, Port Melbourne, Victoria, 3207 (“we”, “us” or “our”).

The warranty

2. This warranty applies to Stiebel Eltron Hand Dryers and Space Heaters – Models HTE 4, HTE 5, ULTRONIC, CNS 100, CNS 150, CNS 200, CNS 250, CK 20S and CKZ 20S (the “unit”) manufactured after 1 May 2015.

3. Subject to the warranty exclusions we will repair or replace, at our absolute discretion, a faulty component in your unit free of charge if it fails to operate in accordance with its specifications during the warranty period.

4. If we repair or replace a faulty component to your unit under this warranty, the warranty period is not extended from the time of the repair or replacement.

5. The warranty period commences on the date of purchase of the unit. Where the date of purchase is not known, then the warranty period will commence 2 months after the date of manufacture.

6. The warranty period for a unit is shown in the table below.

| Component | Warranty period |
|----------------|--|
| All components | 5 years from the date of purchase of the unit. |

Your entitlement to make a warranty claim

7. You are entitled to make a warranty claim if:

7.1. you own the unit or if you have the owner’s consent to represent the owner of the unit;

7.2. you contact us within a reasonable time of discovering the problem with the unit;

How you make a warranty claim

8. To make a warranty claim you must provide us with the following information:

8.1. The model number of the unit;

8.2. A description of the problem with the unit;

8.3. The name, address and contact details (such as phone number and e-mail address) of the owner;

8.4. The address where the unit is installed and the location (e.g. in living room);

8.5. The serial number of the unit;

8.6. The date of purchase of the unit and the name of the seller of the unit;

8.7. The date of installation of the unit where appropriate;

8.8. A copy of the certificate of compliance when the unit was installed where appropriate.

9. The contact details for you to make your warranty claim are:

Name: Stiebel Eltron (Aust) Pty Ltd
Address: 294 Salmon Street, Port Melbourne, Victoria, 3207
Telephone: 1800 153 351
(8.00 am to 5.00 pm AEST Monday to Friday)
Contact person: Customer Service Representative
E-mail: service@stiebel-eltron.com.au

10. We will arrange a suitable time with you to inspect and test the unit.

Warranty exclusions

11. We may reject your warranty claim if:

11.1. The unit was not installed by registered and qualified tradespeople, where required.

11.2. The unit was not installed and commissioned:

(a) in Australia;

(b) in accordance with the Operating and Installation Guide; and

(c) in accordance with the relevant statutory and local requirements of the State or Territory in which the unit is installed.

11.3. The unit has not been operated or maintained in accordance with the Operating and Installation Guide.

11.4. The unit does not bear its original Serial Number or Rating Label.

11.5. The unit was damaged by any or any combination of the following:

(a) normal fair wear and tear;

(b) connection to an incorrect power supply;

(c) connection to faulty equipment, such as faulty circuit breaker;

(d) accidental damage;

(e) act of God, including damage by flood, storm, fire, lightning strike and the like;

(f) wiring not to AS3000 Standards;

(g) ingress of vermin

11.6. The unit was damaged before it was installed e.g. it was damaged in transit.

11.7. An unauthorised person has modified, serviced, repaired or attempted to repair the unit without our consent.

11.8. Non genuine parts other than those manufactured or approved by us have been used on the unit.

12. We may charge you:

12.1. for any additional transport costs if the unit is installed more than 30 kilometres from our closest authorised service technician.

12.2. for the extra time it takes our authorised service technician to access the unit for inspection and testing if it is not sited in accordance with the Operating and Installation Guide and not readily accessible for inspection.

12.3. for any extra costs of our authorised service technician to make the unit safe for inspection.

13. You must ensure that access to the unit by our authorised service technician is safe and free from obstruction.

14. Our authorised service technician may refuse to inspect and test the unit until you provide safe and free access to it, at your cost.

15. If we reject your warranty claim in accordance with clause 11, we may charge you for our authorised service technician's labour costs to inspect and test the unit.

16. In order to properly test the unit we may remove it to another location for testing.

Australian Consumer Law

17. Our goods come with guarantees that cannot be excluded under the Australian Consumer Law. You are entitled to a replacement or refund for a major failure and compensation for any other reasonably foreseeable loss or damage. You are also entitled to have the goods repaired or replaced if the goods fail to be of acceptable quality and the failure does not amount to a major failure.

18. The Stiebel Eltron warranty for the unit is in addition to any rights and remedies you may have under the Australian Consumer Law.

Deutschland

STIEBEL ELTRON GmbH & Co. KG
Dr.-Stiebel-Straße 33 | 37603 Holzminden
Tel. 05531 702-0 | Fax 05531 702-480
info@stiebel-eltron.de
www.stiebel-eltron.de

Verkauf

Kundendienst

Ersatzteilverkauf

Tel. 05531 702-110 | Fax 05531 702-95108 | info-center@stiebel-eltron.de
Tel. 05531 702-111 | Fax 05531 702-95890 | kundendienst@stiebel-eltron.de
Tel. 05531 702-120 | Fax 05531 702-95335 | ersatzteile@stiebel-eltron.de

Australia

STIEBEL ELTRON Australia Pty. Ltd.
294 Salmon Street | Port Melbourne VIC 3207
Tel. 03 9645-1833 | Fax 03 9644-5091
info@stiebel-eltron.com.au
www.stiebel-eltron.com.au

Austria

STIEBEL ELTRON Ges.m.b.H.
Gewerbegebiet Neubau-Nord
Margaritenstraße 4 A | 4063 Hörsching
Tel. 07221 74600-0 | Fax 07221 74600-42
info@stiebel-eltron.at
www.stiebel-eltron.at

Belgium

STIEBEL ELTRON bvba/sprl
't Hofveld 6 - D1 | 1702 Groot-Bijgaarden
Tel. 02 42322-22 | Fax 02 42322-12
info@stiebel-eltron.be
www.stiebel-eltron.be

China

STIEBEL ELTRON (Tianjin) Electric Appliance Co., Ltd.
Plant C3, XEDA International Industry City
Xiqing Economic Development Area
300385 Tianjin
Tel. 022 8396 2077 | Fax 022 8396 2075
info@stiebeleltron.cn
www.stiebeleltron.cn

Czech Republic

STIEBEL ELTRON spol. s r.o.
Dopraváků 749/3 | 184 00 Praha 8
Tel. 251116-111 | Fax 235512-122
info@stiebel-eltron.cz
www.stiebel-eltron.cz

Finland

STIEBEL ELTRON OY
Kapinakuja 1 | 04600 Mäntsälä
Tel. 020 720-9988
info@stiebel-eltron.fi
www.stiebel-eltron.fi

France

STIEBEL ELTRON SAS
7-9, rue des Selliers
B.P. 85107 | 57073 Metz-Cédex 3
Tel. 0387 7438-88 | Fax 0387 7468-26
info@stiebel-eltron.fr
www.stiebel-eltron.fr

Hungary

STIEBEL ELTRON Kft.
Gyár u. 2 | 2040 Budaörs
Tel. 01 250-6055 | Fax 01 368-8097
info@stiebel-eltron.hu
www.stiebel-eltron.hu

Japan

NIHON STIEBEL Co. Ltd.
Kowa Kawasaki Nishiguchi Building 8F
66-2 Horikawa-Cho
Saiwai-Ku | 212-0013 Kawasaki
Tel. 044 540-3200 | Fax 044 540-3210
info@nihonstiebel.co.jp
www.nihonstiebel.co.jp

Netherlands

STIEBEL ELTRON Nederland B.V.
Daviotenweg 36 | 5222 BH 's-Hertogenbosch
Tel. 073 623-0000 | Fax 073 623-1141
info@stiebel-eltron.nl
www.stiebel-eltron.nl

New Zealand

Stiebel Eltron NZ Limited
61 Barrys Point Road | Auckland 0622
Tel. +64 9486 2221
info@stiebel-eltron.co.nz
www.stiebel-eltron.co.nz

Poland

STIEBEL ELTRON Polska Sp. z o.o.
ul. Działkowa 2 | 02-234 Warszawa
Tel. 022 60920-30 | Fax 022 60920-29
biuro@stiebel-eltron.pl
www.stiebel-eltron.pl

Russia

STIEBEL ELTRON LLC RUSSIA
Urzhumskaya street 4,
building 2 | 129343 Moscow
Tel. +7 495 125 0 125
info@stiebel-eltron.ru
www.stiebel-eltron.ru

Slovakia

STIEBEL ELTRON Slovakia, s.r.o.
Hlavná 1 | 058 01 Poprad
Tel. 052 7127-125 | Fax 052 7127-148
info@stiebel-eltron.sk
www.stiebel-eltron.sk

Switzerland

STIEBEL ELTRON AG
Industrie West
Gass 8 | 5242 Lupfig
Tel. 056 4640-500 | Fax 056 4640-501
info@stiebel-eltron.ch
www.stiebel-eltron.ch

Thailand

STIEBEL ELTRON Asia Ltd.
469 Moo 2 Tambol Klong-Jik
Amphur Bangpa-In | 13160 Ayutthaya
Tel. 035 220088 | Fax 035 221188
info@stiebeleltronasia.com
www.stiebeleltronasia.com

United Kingdom and Ireland

Stiebel Eltron UK Ltd.
Unit 12 Stadium Court
Stadium Road | CH62 3RP Bromborough
Tel. 0151 346-2300 | Fax 0151 334-2913
info@stiebel-eltron.co.uk
www.stiebel-eltron.co.uk

United States of America

STIEBEL ELTRON, Inc.
17 West Street | 01088 West Hatfield MA
Tel. 0413 247-3380 | Fax 0413 247-3369
info@stiebel-eltron-usa.com
www.stiebel-eltron-usa.com

STIEBEL ELTRON



Irrtum und technische Änderungen vorbehalten! | Subject to errors and technical changes! | Sous réserve d'erreurs et de modifications techniques! | Onder voorbehoud van vergissingen en technische wijzigingen! | Salvo error o modificação técnica! | Excepto erro ou alteração técnica | Zastrzeżone zmiany techniczne i ewentualne błędy | Omyly a technické změny jsou vyhrazeny! | A muszáki változtatások és tévedések jogát fenntartjuk! | Отсутствие ошибок не гарантируется. Возможны технические изменения. | Chyby a technické zmeny sú vyhradené!

Stand 9646